

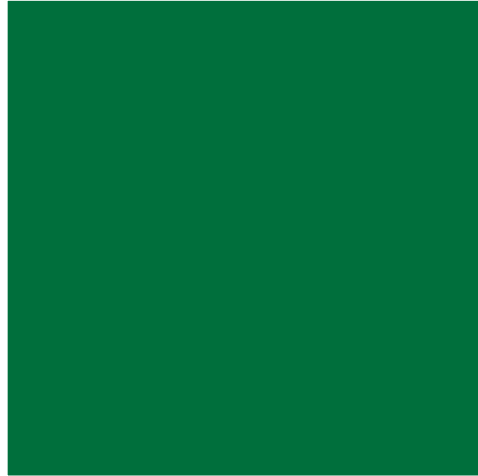

Install Atrium • Instill Confidence



Premium Vinyl Windows and Doors for New Construction

Series 6000HS Horizontal Sliding Windows

Available in sliding, picture window and matching #6000SH single-hung window.

- 3/4" insulated glass provides energy saving, thermal efficiency
- Warm-edge, insulated glass technology reduces condensation up to 80%
- Precision-mitered, fusion-welded corners provide superior strength and weather resistance
- Double aluminum-reinforced interlocks provide a weather tight seal and added security
- Double weather-strip at interlock prevents air and water infiltration
- Multi-chambered frame assembly improves thermal performance and helps enhance sound absorbency
- Sliding sash lifts out for safe, easy cleaning from the inside
- Tandem wheel and axle assemblies assure smooth easy operation and even reveals
- High glass to frame ratio provides maximum viewing area
- Cam-lock and keeper help provide a weather tight seal and added security
- Features a 1" nail-fin setback

Custom Options

- Low-E Glass for additional energy efficiency

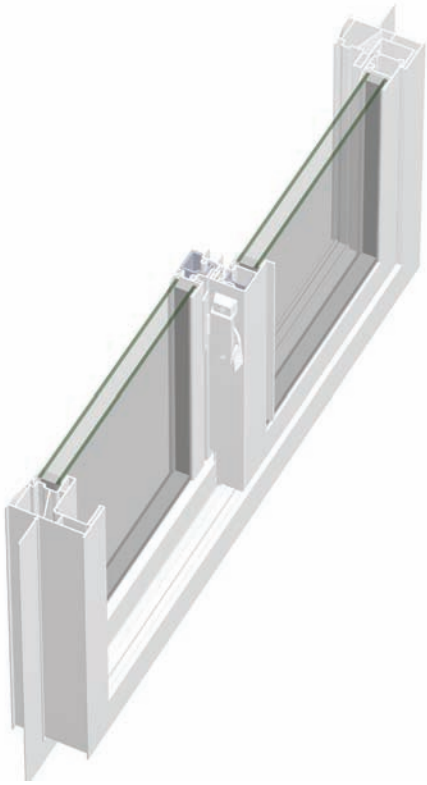

Limited Lifetime Warranty
Color Options: White, Almond

Series 6000SH Single-Hung

Available in single-hung, picture window and matching #6000HS horizontal sliding window.

- 3/4" insulated glass provides energy saving, thermal efficiency
- Warm-edge, insulated glass technology reduces condensation up to 80%
- Precision-mitered, fusion-welded corners provide superior strength and weather resistance
- Double aluminum-reinforced interlocks provide a weather tight seal and added security
- Double silicon treated fin seal weather-strip blocks moisture, resists rot and seals out weather
- Multi-chambered frame assembly improves thermal performance and helps enhance sound absorbency
- Removable sash makes it easy to clean window from the inside
- Cam-lock and keeper help provide a weather tight seal and added security
- High glass to frame ratio provides maximum viewing area
- Integral finger pulls make it easy to open/close window
- Features a 1" nail-fin setback

Custom Options

- Low-E Glass for additional energy efficiency

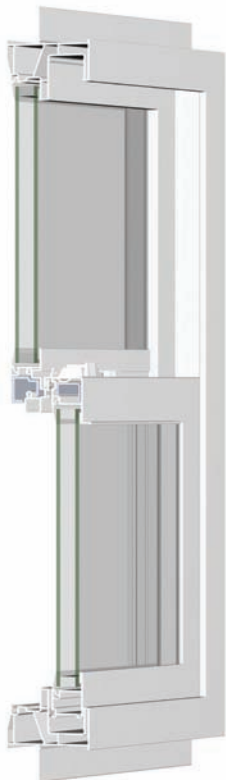

Limited Lifetime Warranty
Color Options: White, Almond

Series 8000 Horizontal Sliding Windows

- 7/8" Insulated glass provides energy saving, thermal efficiency
- Warm-edge, insulated glass technology reduces condensation up to 80%
- Precision-mitered/fusion-welded corners block moisture, resists rot and seals out weather
- Commercial grade structural integrity qualifies this window for use in a wide variety of construction applications
- Commercial grade, heavy-duty construction is 100 MPH wind-zone rated for exceptional performance in extreme weather conditions
- Extra heavy-duty wall thickness engineered into vinyl frame and sash for superior durability and thermal performance
- Multi-chambered frame assembly improves thermal performance and helps enhance sound absorbency
- Double, steel reinforced interlocks provide exceptional structural integrity/strength and comforting security
- High-pile weatherstrip at interlock prevents air and dust infiltration
- Adjustable tandem wheel and axle assemblies assure smooth ease of operation and even reveals
- Positive action cam-lock helps provide a weather-tight seal and added security
- Equal glass size provides visual symmetry in the use of internal grid patterns
- Integral, prepunched mounting flange targets proper nail location for quick, easy installation
- Dual, concealed drainage system keeps rain where it belongs – outside
- Choice of White, Adobe or Almond color options



Series 8100 Single-Hung Windows

- 7/8" Insulated glass provides energy saving, thermal efficiency
- Warm-edge, insulated glass technology reduces condensation up to 80%
- Precision-mitered/fusion-welded corners provide superior structural strength and weather resistance
- Commercial grade structural integrity qualifies this window for use in a wide variety of construction applications
- Commercial grade, heavy-duty construction is 100 MPH wind-zone rated for exceptional performance in extreme weather conditions
- Extra heavy-duty wall thickness engineered into vinyl frame and sash for superior durability and thermal performance
- Multi-chambered frame assembly improves thermal performance and helps enhance sound absorbency
- Double steel reinforced meeting rails provide superior strength and rigidity
- Silicon treated fin seal weatherstrip blocks moisture, resists rot and seals out weather
- Removable sash makes it easy to clean the window from the inside
- Positive action cam-lock helps provide a weather-tight seal and comforting security
- Integral finger pulls make it easy to open/close window
- Contoured glazing stop creates a subtle exterior elegance
- Dual, concealed drainage system keeps rain where it belongs – outside
- Integral, prepunched mounting flange targets proper nail location for quick, easy installation
- Choice of White, Adobe or Almond color options



Series 8400 Vinyl Door

- n** Elegant slim line design adds style, value and comfort to any home
- n** 7/8" tempered, insulated glass with warm-edge technology provides safety and optimum energy efficiency
- n** Multi-chambered vinyl extrusions enhance thermal performance
- n** Fusion welded frame and sash provides exceptional structural strength
- n** Steel reinforced door panels enhance overall durability
- n** Adjustable, tandem steel wheels and heavy duty hardware provide smooth, easy operation
- n** Hidden drainage systems in frame and sash assure a watertight structure
- n** Equal size glass lites and a high glass to vinyl ratio make the 8400 one of the most architecturally attractive patio doors available

Size guidelines:

Minimum width - 48"

Maximum width - 108"

Minimum height - 72"

Maximum height - 96"



Series 370 French Door

- n** Elegant garden door appearance with an extra-wide 6" bottom rail
- n** 1" tempered, insulated glass with warm-edge technology provides safety and optimum energy efficiency
- n** Multi-chambered vinyl extrusions enhance thermal performance
- n** Fusion welded frame provides exceptional structural strength
- n** Mechanically assembled sashes at a 90 degree angle
- n** Additionally reinforced meeting rail for structural integrity
- n** Multi-point locking system provides superior pull-in mechanism and structural performance
- n** Internal weeping system in frame for maximum water drainage efficiency
- n** Heavy-duty zinc die-cast handle for years of durability
- n** Available in two, three and four panel construction
- n** Optional decorative grids
- n** Optional Low-E glass



Series 1600 Vinyl Hinged Door

- n Beauty and elegance in a high-performance vinyl hinged door
- n Warm-edge insulated glass technology reduces condensation
- n Integrated 1 3/8" pre-punched nailing fin for easy installation
- n 5 - 15/16" wide frame (4-9/16" from nailing fin)
- n Internal weeping system for maximum water drainage efficiency
- n Heavy-duty weather strip to minimize air and water infiltration
- n Superior sill weather strip is ultra-resistant to wear and tear
- n Anodized extruded Champaign aluminum sill cover is corrosion resistant with a thermal break and an integral rolling track for optional screen
- n Available in one, two, three and four panel configurations
- n Optional decorative grids
- n Optional Low-E glass
- n Optional decorative glass



Shapes

From octagons and trapezoids to full circle, half rounds and eyebrows, Atrium offers a full range of architectural options to accommodate any style.

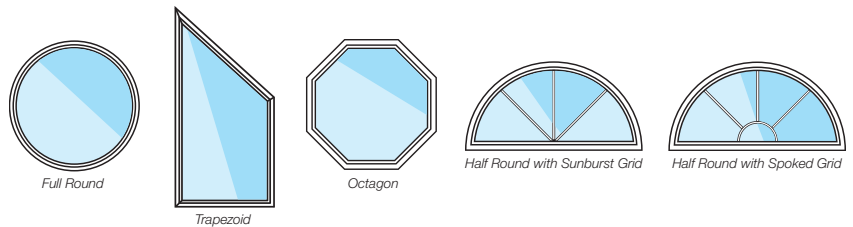

Optional Energy Saving Low-E Glass Technology

Low-E glass is coated with a virtually invisible layer of silver that reflects radiant solar energy while permitting visible light to pass through the glass. In cold, winter climates the Low-E glass helps keep rooms warmer by reflecting heat back into the home while letting warm, solar rays in. In hot, summer temperatures the Low-E glass lets visible light pass while blocking infrared and ultraviolet radiant solar energy. So your rooms stay cooler and you save on precious energy costs. An added bonus of Low-E glass, blocking radiant solar energy, also helps protect room furnishings from fading.

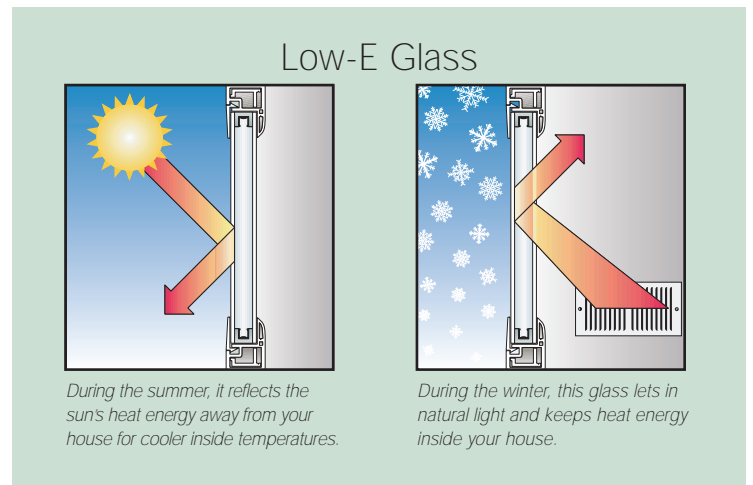

The Atrium Warranty

You'll like what's behind our windows: a limited lifetime warranty on vinyl, glass, and all working parts. We register each product individually, with its own product identification number (PIN) for easy replacement of parts.



12775 East 38th Avenue • Denver, CO 80239
www.atriumwindows.com

Kids Can't Fly
Screens are not designed to restrain a child from falling through an open window. Please take proper precautions.

Distributed by: